



SOKHA PHNOM PENH HOTEL & RESIDENCE

Strategically located on Chroy Changvar peninsular, overlooking the spectacular Chaktomuk River, opposite the majestic Royal Palace. Sokha Phnom Penh Hotel & Residence is the best choice both for leisure and business travelers. Located approximately 13km from Phnom Penh International Airport and only 10 minutes drive to commercial street, historical landmarks, popular Royal Palace, Wat Phnom, Night Market, Central Market, Sorya Mall, Aeon Mall, National Museum, Independence Monument and other popular tourist attractions.



TRANSPORTATION

| FROM | DURATION | BY | FROM | DURATION | BY |
|-----------------|----------|---------------|-----------------------|----------|--------------|
| Wat Phnom | 4 km | Remork Car | Royal Palace | 6 km | Remork Car |
| Night Market | 4.5 km | Remork Car | Riverside | 6 km | Remork Car |
| Central Market | 5 km | Remork Car | Independence Monument | 6 km | Remork Car |
| Sorya Mall | 5 km | Remork Car | Aeon Mall | 9.2 km | Remork Car |
| National Museum | 6 km | Remork Car | Phnom Penh Airport | 13 km | Remork Car |
| Koh Pich | 2 km | Hotel's Ferry | Aeon Mall II | 9.4 km | Remork Car |

ACCOMMODATION

The hotel consists of 549 spacious well-appointed luxurious rooms and suites with the leading category rooms starting from 52 sqm or 560sqm. Decorated in contemporary elegance and balanced with True Khmer hospitality, the hotel creates a warm and sincere invitation to stay. In addition, all guests can enjoy complimentary Wi-Fi throughout the hotel rooms, public areas and Food & Beverages areas.

| ROOM TYPES | NUMBER OF ROOM | AREA (SQM) | FLOORS |
|-------------------|----------------|------------|-------------|
| Deluxe | 261 | 52 | 3 F - 18 F |
| Premier | 234 | 56 | 3 F - 18 F |
| Club Suite | 26 | 71 | 3 F - 18 F |
| Junior Suite | 13 | 93 | 3 F - 18 F |
| Executive Suite | 13 | 146 | 3 F - 18 F |
| Royal Sokha Suite | 2 | 318 | 16 F - 18 F |

RESTAURANTS AND BARS

The hotel has multi-unit restaurants and bars offering global cuisine with charming views. Discover the international culinary journey with us!

LOTUS RESTAURANT

Enjoy stunning river view and indulge in international selection buffet breakfast, with large selection of cold and hot foods, homemade pastries, rolls and bread at our all-day dining restaurant, The Lotus, it's a perfect choice for all-day dining!

Operation: Mon-Sun

Breakfast: 06:00 – 10:00 | Lunch | Dinner: available for private events | Capacity: 300 persons

Lobby Floor

CHAMPA CAFÉ

A laid-back atmosphere with breathtaking river view, Champa Café is a place designed for both leisure and business meeting. Offering freshly brewed coffee and a choice of delicious light bites, you can enjoy your alone time or being with friends.

Operation: Mon-Sun

08:00 – 12:00 | Capacity: 130 persons

Lobby Floor

BEL CIBO RESTAURANT

From a spectacular interior to an exquisite array of Italian cuisine, The Bel Cibo brings out the most ideal atmosphere for an amazing Italian experience. The restaurant is influenced by Tuscany and the northern regions of Italy serving prime cuts of meats, poultry, seafood and homemade pastas, home-cured olives, marinated vegetables and mushrooms in virgin olive oil will deliver a delicate palette of flavors to enhance the dining experience. Homemade breads, delightful dessert and cheeses served with selection of premium wines. It is the ultimate Italian dining experience away from home and here in Phnom Penh with an excellent view of the river and city.

Operation: Mon-Sun

Dinner: 18:00 – 22:00 | Capacity: 120 persons

19th Floor

CHINA HOUSE RESTAURANT

Refined and well-furnished interior decoration, The China House offers Regional Chinese specialties from Guangdong, Sichuan, Hunan and Beijing. The famous Peking Duck and roasted meat platters, fresh seafood and seasonal specialties as crab, abalone, sea cucumber and lobster will be served for any hosting or family celebration. The private rooms with VIP setups and custom-made set menu are available for a nice meal with family and friends, or to host a business luncheon.

Operation: Mon-Sun

Lunch: 11:00 – 14:30 | Dinner: 18:00 – 22:00

Capacity: 120 persons | Lobby Floor



TAKEZONO RESTAURANT

In a warm and intimate atmosphere on the 19th floor, Takezono is the only one sky-high Japanese restaurant in Phnom Penh providing authentic Japanese cuisine. High-lighted hand craft sushi, maki rolls, fresh sashimi from premium seafood with condiments from our sushi bar, teppanyaki in public and private rooms, and the restaurant also promote premium Sake, whisky and beers.

Operation: Mon-Sun

Dinner: 18:00 – 22:00 | Capacity: 120 persons

19 Floor

STARDUST KTV

Luxurious entertaining facilities. Stardust KTV is now one of the nicest KTV studios in Cambodia. A beautifully designed rooms has its own deluxe theme, and its karaoke rooms are adorned with attractive entertaining stuff like rotating disco ball, colorful lightings, and laser effects and with large screens with 36 rooms and there are three type of small, medium and big room for your entertainment leisure. Stardust is a great place for organizing group events: away from the city, quiet, enjoyable ambience, and professional service are what make Stardust a nice place to hold fun gathering like birthday parties, theme parties, bachelor nights and ladies nights.

Operation: Mon-Sun

12:00 – 02:00

K Floor

CONFERENCE CENTRE AND MEETING SPACES

The largest 5-Star hotel convention facility in Kingdom of Cambodia!

Sokha Phnom Penh Hotel & Residence offers various venues including grand ballroom of 2,728 square meters can accommodate up to 3,000 guests with additional of 9 multi-purposes breakout rooms and total of 2,269 square meters, indoor and outdoor exhibition space with total area of 6,483 square meters.

| ROOM TYPE | Measurement (Meter) | Height (Meter) | Theater | Classroom | U-shape | Boardroom | Cocktail Reception | Banquet Set menu | Buffet |
|----------------|---------------------|----------------|---------|-----------|---------|-----------|--------------------|------------------|--------|
| Ballroom I | 31 x 29 | 8 | 700 | 400 | 145 | 145 | 800 | 540 | 300 |
| Ballroom II | 31 x 30 | 8 | 750 | 432 | 150 | 150 | 850 | 540 | 320 |
| Ballroom III | 31 x 29 | 8 | 700 | 400 | 145 | 145 | 800 | 540 | 300 |
| Grand Ballroom | 31 x 88 | 8 | 2500 | 1500 | 440 | 440 | 2000 | 1600 | 1100 |
| Yihub | 11 x 10 | 3.4 | 85 | 35 | 35 | 24 | 80 | 50 | 50 |
| Malisrouth | 16 x 7 | 3.4 | 110 | 60 | 40 | 34 | 145 | 60 | 60 |
| Kravan | 16 x 7 | 3.4 | 110 | 60 | 40 | 34 | 145 | 60 | 60 |
| Nakry | 16 x 7 | 3.4 | 110 | 60 | 40 | 34 | 145 | 60 | 60 |
| Champey | 16 x 10 | 3.4 | 130 | 84 | 60 | 40 | 130 | 90 | 60 |
| Rumdoul | 11 x 8 | 3.4 | 72 | 36 | 35 | 22 | 80 | 40 | 40 |
| Bompong krolom | 11 x 8 | 3.4 | 72 | 36 | 35 | 22 | 80 | 40 | 40 |
| Romchong | 11 x 8 | 3.4 | 72 | 36 | 35 | 22 | 80 | 40 | 40 |
| Raingsap | 10 x 30 | 3.4 | 180 | 140 | 80 | 80 | 150 | 140 | 70 |

FLOOR PLAN

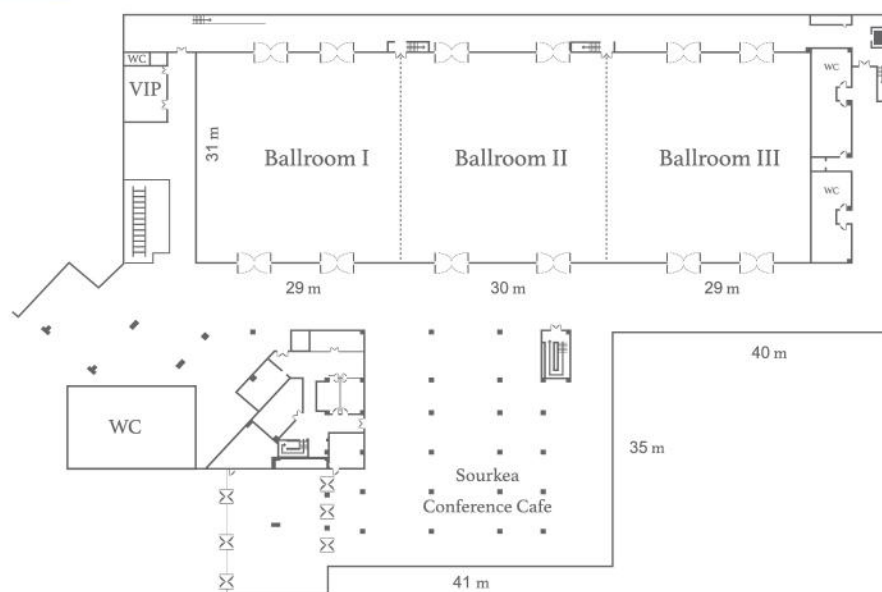

Sokha Phnom Penh Hotel & Residence

Street Keo Chenda, Phum 1, Sangkat Chroy Changvar, Khan Chroy Changvar | Phnom Penh | Kingdom of Cambodia

E: reservation.fopp@sokhahotels.com | T: +855 23 685 8888 | F: +855 23 685 7777

www.sokhahotels.com.kh

TONLE SAP BAR

A popular hang-out for Phnom Penh's jet-set and cultivated travellers, this sophisticated bar does justice to its name with unrivalled 360 degree views – overlooking a magnificent cityscape, Royal Palace and Tonle Sap River just to name a few – there is a good reason this bar is top of most visitor "to do list". Drinks are moderately priced and there are demarcated smoking zones.

Take the lift to the 20th floor and watch in awe as the world goes by. Let the romantic mood and gentle jazz wash over you, while enjoying sensational views of the Cambodia capital.

Operation: Mon-Sun

Dinner: 18:00 – 22:00 | Capacity: 250 persons

Fridays & Saturdays: Weekend B.B.Q Buffet

Entertained by local live band

20 Floor

JASMINE SPA

Enjoy a relaxing day at Jasmine Spa and receive the best treatment for your body, mind and soul. Jasmine Spa offers a wide variety of services which your will enjoy and experience the best spa therapy.

Operation: Mon-Sun

07:00-22:00

M Floor